

2

1

Model #	A Diameter	B Blade length	C Blade width	D Blade thickness	E Plate Diameter	F Plate Thickness	G Hub Diameter	H Hub Depth	I Max Bore	J set screws
6BR-3	3	0.75	0.6	0.125	2	0.1875	1.25	1.25	0.75	(2) 1/4-20
6BR-4	4	1	0.8	0.125	2.625	0.1875	1.25	1.25	0.75	(2) 1/4-20
6BR-5	5	1.25	1	0.125	3.375	0.1875	1.25	1.25	0.75	(2) 1/4-20
6BR-6	6	1.5	1.2	0.125	4	0.1875	1.25	1.25	0.75	(2) 1/4-20
6BR-7	7	1.75	1.4	0.125	4.625	0.1875	1.5	1.5	0.75	(2) 5/16-18
6BR-8	8	2	1.6	0.125	5.375	0.1875	1.5	1.5	0.75	(2) 5/16-18
6BR-9	9	2.25	1.8	0.125	6	0.1875	1.5	1.5	0.75	(2) 5/16-18
6BR-10	10	2.5	2	0.125	6.625	0.1875	1.5	1.5	0.75	(2) 5/16-18
6BR-11	11	2.75	2.2	0.1875	7.375	0.1875	1.75	1.75	1.25	(2) 3/8-16
6BR-12	12	3	2.4	0.1875	8	0.1875	1.75	1.75	1.25	(2) 3/8-16
6BR-13	13	3.25	2.6	0.1875	8.625	0.1875	1.75	1.75	1.25	(2) 3/8-16
6BR-14	14	3.5	2.8	0.1875	9.375	0.1875	2	2	1.5	(2) 3/8-16
6BR-15	15	3.75	3	0.1875	10	0.1875	2	2	1.5	(2) 3/8-16
6BR-16	16	4	3.2	0.25	10.675	0.25	2	2	1.5	(2) 1/2-13
6BR-17	17	4.25	3.4	0.25	11.375	0.25	3.5	3.5	2.5	(2) 1/2-13
6BR-18	18	4.5	3.6	0.25	12	0.25	3.5	3.5	2.5	(2) 1/2-13
6BR-19	19	4.75	3.8	0.25	12.675	0.25	3.5	3.5	2.5	(2) 1/2-13
6BR-20	20	5	4	0.25	13.375	0.25	3.5	3.5	2.5	(2) 1/2-13
6BR-21	21	5.25	4.2	0.25	14	0.25	3.5	3.5	2.5	(2) 1/2-13
6BR-22	22	5.5	4.4	0.25	14.675	0.25	3.5	3.5	2.5	(2) 1/2-13
6BR-23	23	5.75	4.6	0.25	15.375	0.25	3.5	3.5	2.5	(2) 1/2-13
6BR-24	24	6	4.8	0.25	16	0.25	3.5	3.5	2.5	(2) 1/2-13
6BR-25	25	6.25	5	0.25	16.675	0.25	3.5	3.5	2.5	(2) 1/2-13
6BR-26	26	6.5	5.2	0.25	17.375	0.25	3.5	3.5	2.5	(2) 1/2-13

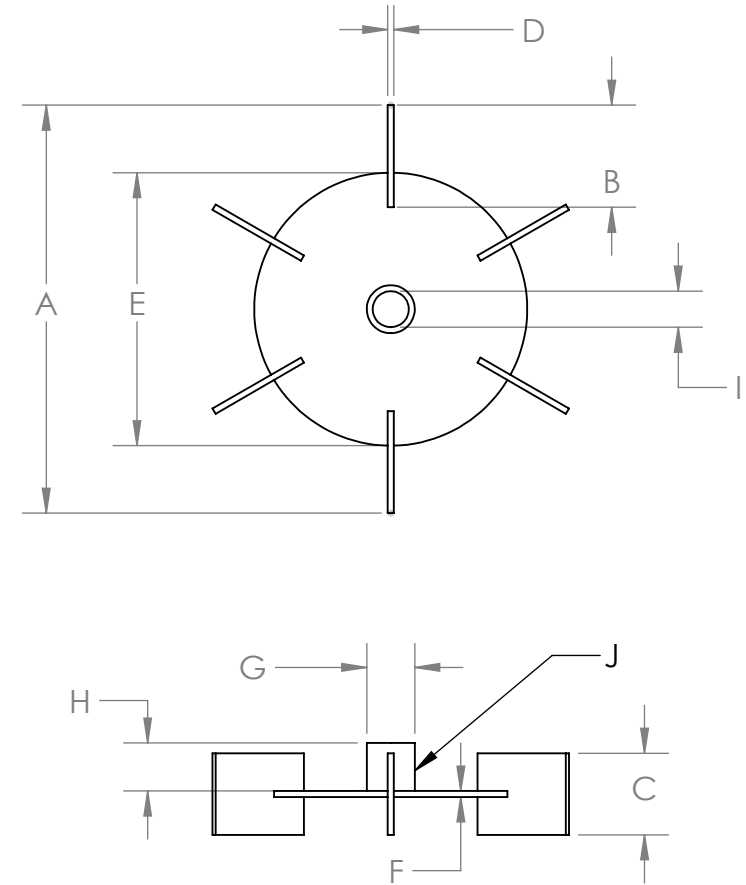

NOTE: ALL DIMENSIONS ARE REFERENCE ONLY

$N_q = 0.72$

$N_p = 5.75$

* N_p drops significantly after startup in gas dispersion application

PROPRIETARY AND CONFIDENTIAL

THE INFORMATION CONTAINED IN THIS DRAWING IS THE SOLE PROPERTY OF INDCO INC. ANY REPRODUCTION IN PART OR AS A WHOLE WITHOUT THE WRITTEN PERMISSION OF INCO INC. IS PROHIBITED.

UNLESS OTHERWISE SPECIFIED:

DIMENSIONS ARE IN INCHES
TOLERANCES:
FRACTIONAL $\pm 1/32$
ANGULAR: MACH $\pm .5^\circ$ BEND $\pm 1^\circ$
TWO PLACE DECIMAL $\pm .010"$
THREE PLACE DECIMAL $\pm .005"$

INTERPRET GEOMETRIC
TOLERANCING PER:

MATERIAL
316 SS

FINISH

DO NOT SCALE DRAWING

NAME DATE

DRAWN --- 10/18/17

CHECKED

ENG APPR.

MFG APPR.

Q.A.

COMMENTS:

OTHER MATERIALS
AVAILABLE UPON
REQUEST

INDCO INC.

TITLE: **RUSHTON IMPELLER
6-bladed Rushton
style impeller**

SIZE DWG. NO. REV

A Tabulated Rushton

SCALE: 1:8 WEIGHT: SHEET 1 OF 1

2

1

B

B

A

A